

\$119,000 - 22, 16511 Township Road 532a Subdivision, Rural Yellowhead County

MLS® #A1128544

\$119,000

0 Bedroom, 0.00 Bathroom,
Land on 4.10 Acres

NONE, Rural Yellowhead County, Alberta

Private subdivision located about 2 miles east of Edson. Gated Community. Lot includes underground services to property line and consists of power, gas, telephone line and high speed internet. Property owners are responsible for there own septic and well. Subdivision is paved.

Essential Information

MLS® #	A1128544
Price	\$119,000
Bathrooms	0.00
Acres	4.10
Type	Land
Sub-Type	Residential Land
Status	Active

Community Information

Address	22, 16511 Township Road 532a
Subdivision	NONE
City	Rural Yellowhead County
County	Yellowhead County
Province	Alberta
Postal Code	T7E 3A6

Additional Information

Date Listed	July 9th, 2021
Days on Market	1442

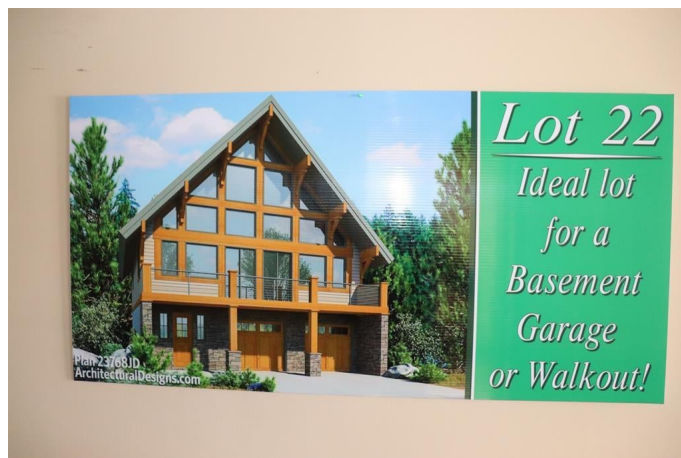

Zoning

CR

Listing Details

Listing Office

RE/MAX BOXSHAW FOUR REALTY

Data is supplied by Pillar 9â„¢ MLS® System. Pillar 9â„¢ is the owner of the copyright in its MLS® System. Data is deemed reliable but is not guaranteed accurate by Pillar 9â„¢. The trademarks MLS®, Multiple Listing Service® and the associated logos are owned by The Canadian Real Estate Association (CREA) and identify the quality of services provided by real estate professionals who are members of CREA. Used under license.